

# PVC-U/PE - BALL VALVES BUT WELDING

## MATERIALS

Union ends: PE 100  
Lever: PP/PVC-U  
Sphere backups: PE / TEFLON  
O'ring gaskets: E.P.D.M / VITON  
Body and remaining components: PVC-U

## STANDARDS

These fittings are valid to be used in conducting water and nourishing fluids, based on the laws and standards valid in the countries of the E.E.C.

## ASSEMBLY

The but welding valves: by welding using an appropriate socket fusion machine.

## SERVICE PRESSURE

The nominal service pressure, just as an indication, is of 10 bar at 20°C (water). The maximum temperatures of use must not go beyond 80°C.

## ABBREVIATION INTERPRETATION

d	- Nominal diameter
G	- Nominal diameter of the screw
Quant	- Quantity of fittings that each box contains
Gr	- Approximate weight of fittings in grams
A	- Box 13.5x13.5x12
B	- Box 29x23x16.5
C	- Box 39x29x31

## PVC-U/PE - BALL VALVES BUT WELDING

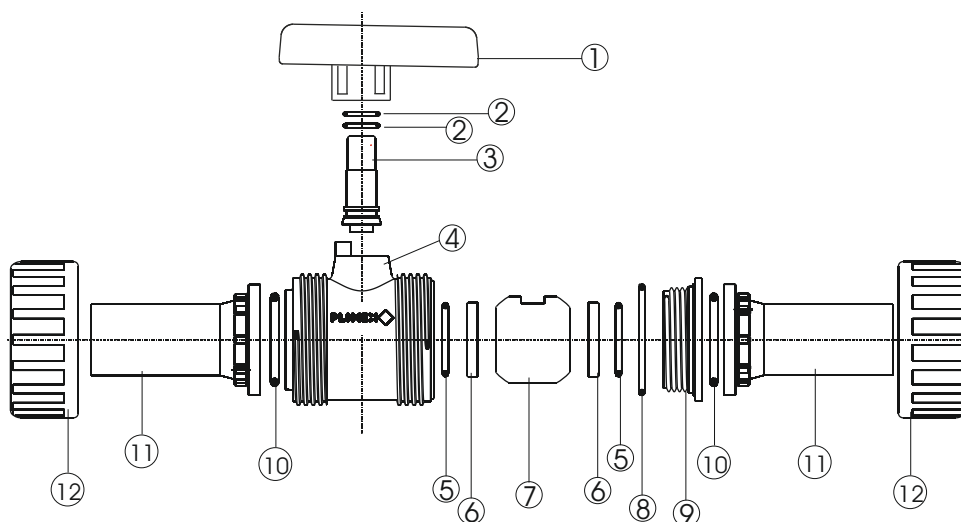

N° REF.	COMPONENT	MATERIAL	QUANT.	N° REF.	COMPONENT	MATERIAL	QUANT.
1	lever	pp pvc-u	1	7	ball	pvc-u	1
2	o'ring	epdm viton	2	8	o'ring	epdm viton	1
3	stem	pvc-u	1	9	thread cap	pvc-u	1
4	body	pvc-u	1	10	o'ring	epdm viton	2
5	o'ring	epdm viton	2	11	union ends	pe 100	2
6	sphere backups	pe ptfe	2	12	nut	pvc-u	2