

PP - COMPACT VALVES

MATERIALS

Lever: PP
Sphere and stem: ABS
Sphere backups: PTFE
O'ring gaskets: E.P.D.M.
Body and remaining components: PP GF

STANDARDS

The screwing valves strictly respect the standards EN 10226-1 and ISO 7/1

ASSEMBLY

The screwing valves: by screwing according to ISO 7/1 recommendations.

SERVICE PRESSURE

The service pressure, just as an indication, is of 10 bar at 20°C (water) up to 2" and is of 6 bar at 20°C (water) of 2"½ and 3".

ABBREVIATION INTERPRETATION

G - Nominal diameter of the screw
Quant - Quantity of fittings that each box contains
Gr - Approximate weight of fittings in grams
B - Box 29 x 23 x 16.5
C - Box 39 x 29 x 31

PP - COMPACT VALVES

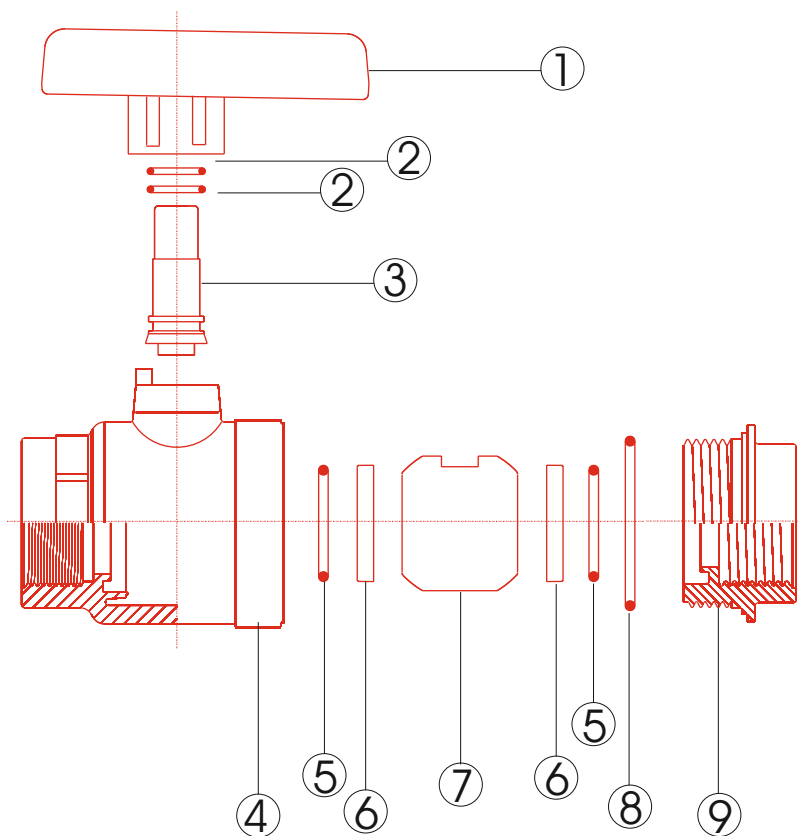

N° REF.	COMPONENT	MATERIAL	QUANT.	N° REF.	COMPONENT	MATERIAL	QUANT.
1	lever	pp	1	6	sphere backups	ptfe	2
2	o'ring	epdm	2	7	ball	abs	1
3	stem	abs	1	8	o'ring	epdm	1
4	body	pp gf	1	9	thread cap	pp gf	1
5	o'ring	epdm	2				