

Válvulas retenção F/F - **SCH80**

**SCH80** - Check valves F/F

Clapets à ressort F/F - **SCH80**

Válvulas anti-retorno H/H - **SCH80**



01 54 1291 000

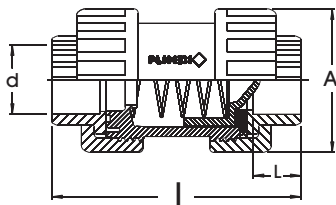

| d      | A   | I   | L  | Gr   | Quant |
|--------|-----|-----|----|------|-------|
| 1/2"   | 48  | 94  | 22 | 104  | B 35  |
| 3/4"   | 68  | 122 | 25 | 270  | C 60  |
| 1"     | 68  | 130 | 29 | 277  | C 48  |
| 1 1/4" | 95  | 158 | 32 | 622  | C 18  |
| 1 1/2" | 95  | 164 | 35 | 630  | C 18  |
| 2"     | 115 | 190 | 38 | 1080 | C 10  |
| 2 1/2" | 151 | 216 | 44 | 2120 | C 4   |
| 3"     | 185 | 249 | 51 | 3250 | C 3   |
| 4"     | 185 | 266 | 61 | 3270 | C 3   |

Nº Código

01 54 1291 020

01 54 1291 025

01 54 1291 032

01 54 1291 040

01 54 1291 050

01 54 1291 063

01 54 1291 075

01 67 1291 090

01 67 1291 110

Terminais de colar fêmea - **SCH80**

**SCH80** -Union ends female

Pièces folles femelle - **SCH80**

Manguitos enlace hembra - **SCH80**



01 54 1384 000

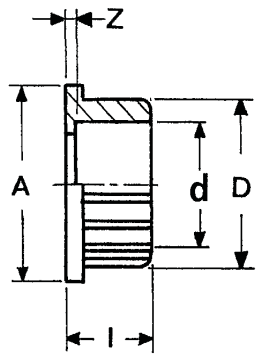

| d      | A    | D   | I  | Z | Gr  | Quant |
|--------|------|-----|----|---|-----|-------|
| " 1/2  | 36   | 28  | 25 | 3 | 11  | A 60  |
| " 3/4  | 50   | 36  | 28 | 3 | 25  | A 30  |
| 1 "    | 50   | 42  | 32 | 3 | 29  | A 20  |
| 1" 1/4 | 74.5 | 52  | 35 | 3 | 60  | B 60  |
| 1" 1/2 | 74.5 | 63  | 38 | 3 | 64  | B 40  |
| 2 "    | 90   | 77  | 44 | 5 | 117 | B 20  |
| 2" 1/2 | 124  | 91  | 49 | 5 | 220 | B 12  |
| 3 "    | 138  | 111 | 58 | 7 | 363 | B 8   |
| 4 "    | 141  | 132 | 64 | 6 | 351 | B 8   |

Nº Código

01 54 1384 020

01 54 1384 025

01 54 1384 032

01 54 1384 040

01 54 1384 050

01 54 1384 063

01 54 1384 075

01 67 1208 090

01 67 1208 110